

AT ELANA 841P

Handling instructions



Seeing beyond

Preparatory steps

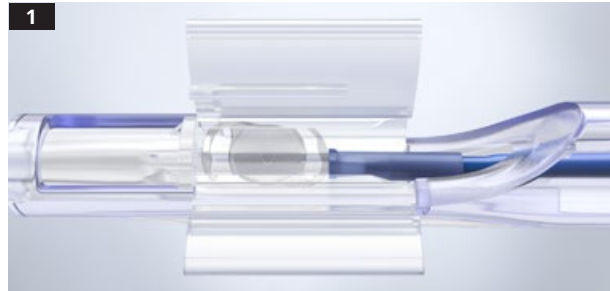

1 Verify the lens is centered and secure in the IOL chamber.

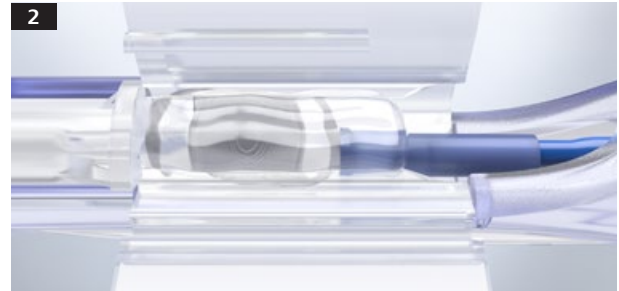

2 Cover the whole lens and blue plunger tip with a **generous** amount of OVD. Avoid touching the lens and blue plunger tip.



3 Close the lid of the IOL chamber.
IMPORTANT: Allow the lens to remain in this position until the surgeon is ready to implant it into the eye.

Implantation steps

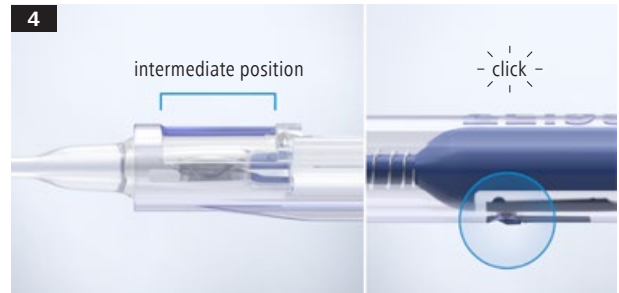

4 Advance the lens to the intermediate position. Gently press the plunger forward until an audible 'click' is heard.
IMPORTANT: The lens should be implanted immediately.

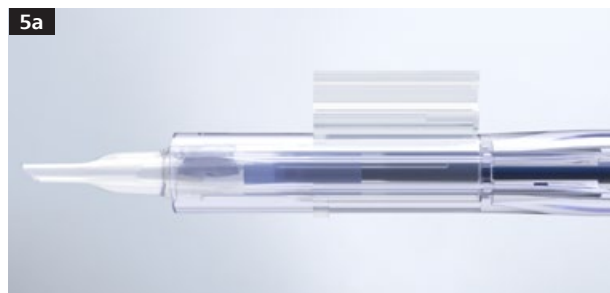

5a Injection: Ensure that loading chamber wings are facing upwards.

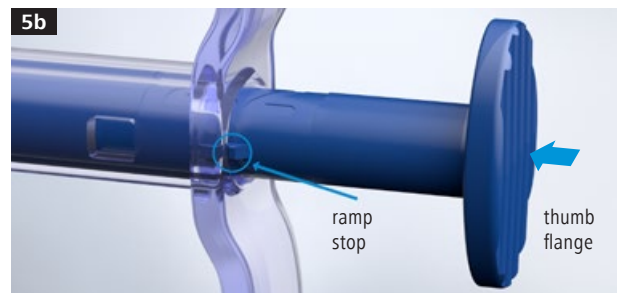

5b Slowly advance the lens until it has been released from the injector. If delivery is incomplete, apply additional force to the thumb flange to release the lens. **Assistance feature:** The ramp stop at the back of the injector helps control excess travel of the plunger at the end of IOL delivery.

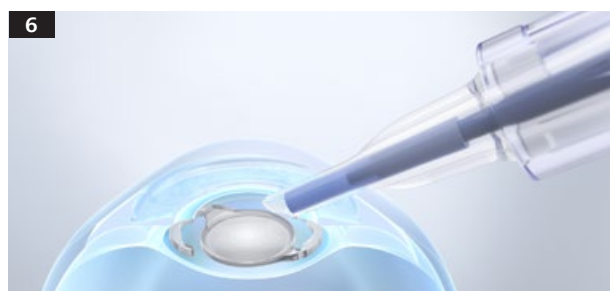

6 Carefully position the lens in the capsular bag.

7 Discard the device. Do not reuse the injector.

CE 0297

AT ELANA 841P



Carl Zeiss Meditec AG

Goeschwitzer Strasse 51–52

07745 Jena

Germany

www.zeiss.com/elana

www.zeiss.com/med/contacts

en-OUS_32_012_00511 Printed in Germany. CZ-XI/2021 International edition: Only for sale in selected countries.
The contents of the brochure may differ from the current status of approval of the product or service offering in your country. Please contact our regional representatives for more information. Subject to changes in design and scope of delivery and due to ongoing technical development. AT ELANA 841P is either a trademark or registered trademark of Carl Zeiss Meditec AG or other companies of the ZEISS Group in Germany and /or other countries.
© Carl Zeiss Meditec AG, 2021. All rights reserved.