

FORUM LINK net from ZEISS

Version 2.0

Connecting non-DICOM instruments
to efficient data management flow – easy and fast

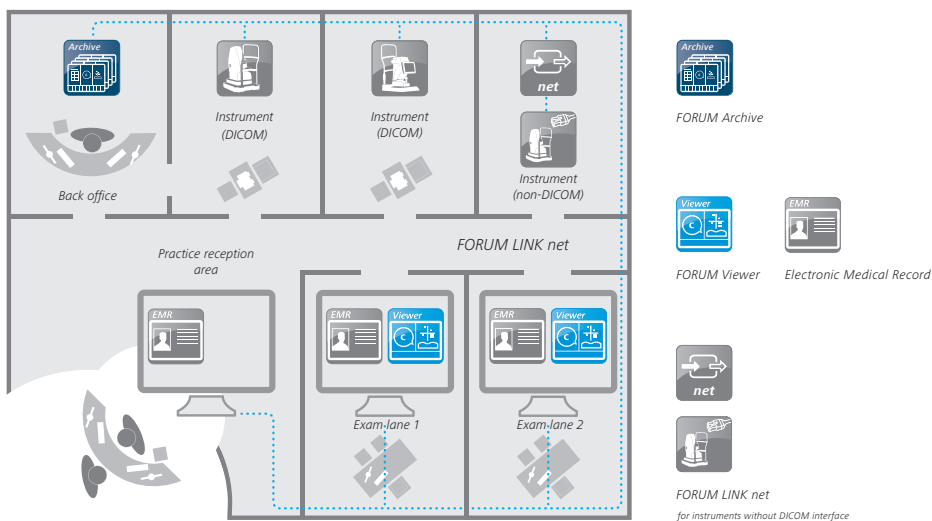

Your challenge

More and more eye care practices are converting to digital data management. Having access to a collection of examination data from all instruments in one place can increase workflow efficiency significantly. Yet the integration and documentation of data from many diagnostic instruments which do not comply to the DICOM standard continue to be very cumbersome. Until now.

Our FORUM solution

With ZEISS FORUM LINK net, instruments from ZEISS as well as other manufacturers which do not have a DICOM interface can be seamlessly integrated into the enhanced data management workflow of ZEISS FORUM. With this application, images or reports from instruments without DICOM interface can be transferred and associated to the correct patient record in FORUM from ZEISS where they are stored as DICOM files. Moreover, patient demographics do not have to be keyed in. Instead, they can be selected from worklists created in ZEISS FORUM.



ZEISS FORUM LINK net

Key benefits

More user friendly:

- Easy rotation of pdfs (90° and 180°)
- Display and processing of images in all prevalent image formats (jpg, png, tif, gif, bmp)
- New user interface
- Possibility to edit additional parameters (like AcquisitionDateTime, Accession number)

More efficient workflow possible through:

- Ability to select laterality individually per image or series
- Option to trigger end of series manually and send pictures any time
- New search parameter "last patient" allows quick finding of patient and saves time
- Easy connection of ZEISS FORUM LINK net to ZEISS FORUM via AutoConnect

Minimum requirements for FORUM LINK net from ZEISS

ZEISS FORUM LINK net 2.0	
Processor	Intel Pentium, 1.8 GHz (or faster)
RAM	1 GB min.
Operating system	Windows 7 SP1 (32 bit or 64 bit), 8.1, 10, Windows Server 2008 R2 SP1, 2012, 2012 R2
Display	Super VGA 800 x 600 pixel or higher
Additional hardware	Keyboard and mouse
Requirements on the instrument side	Network connection



*ZEISS FORUM LINK net
converts data from
non-DICOM instruments
into a DICOM-compatible
format.*

For more information, visit: www.zeiss.com/forum

 **Carl Zeiss Meditec AG**
Goeschwitzer Strasse 51–52
07745 Jena
Germany
www.zeiss.com/forum
www.zeiss.com/med/contacts